

## SWIVEL ARM CLAMP ON



- ▶ Standard mounting to 25 mm and 1" bars, easily removable connection.
- ▶ Easy single screw adjustment.
- ▶ Available in lock pin 16, 19 or ball joint mountings, industry standard.

### TECHNICAL DATA

Description	Unit	Value
Material		Al, Steel
Temperature range	°C	-30-70
Max. load, bar clamp, torque	Nm	40
Max. load, bar clamp	N	400

Operational lifetime: 10,000,000 cycles at max. load

### TECHNICAL DATA, SPECIFIC

Description	Unit	Weight
Swivel arm 50, range	g	285-317
Swivel arm 100, range	g	369-401
Swivel arm 150, range	g	458-490

## ORDERING INFORMATION

1. Rod extension		PMAT Code
Rod Extension 50 length		AA
Rod Extension 100 length		AB
Rod Extension 150 length		AC
2. Bar mounting style		PMAT Code
Bar clamp, clamp-on 25 mm		00
3. Swivel style		PMAT Code
Pin 16		P
Pin 19		C
Ball joint		I
4. Function attachment		PMAT Code
No function attachment		00
Example		Ordering number
PMAT with rod extension 50, bar clamp, clamp-on 25 mm, pin 16 swivel style, no function attachment		PMAT AA 00 P 00

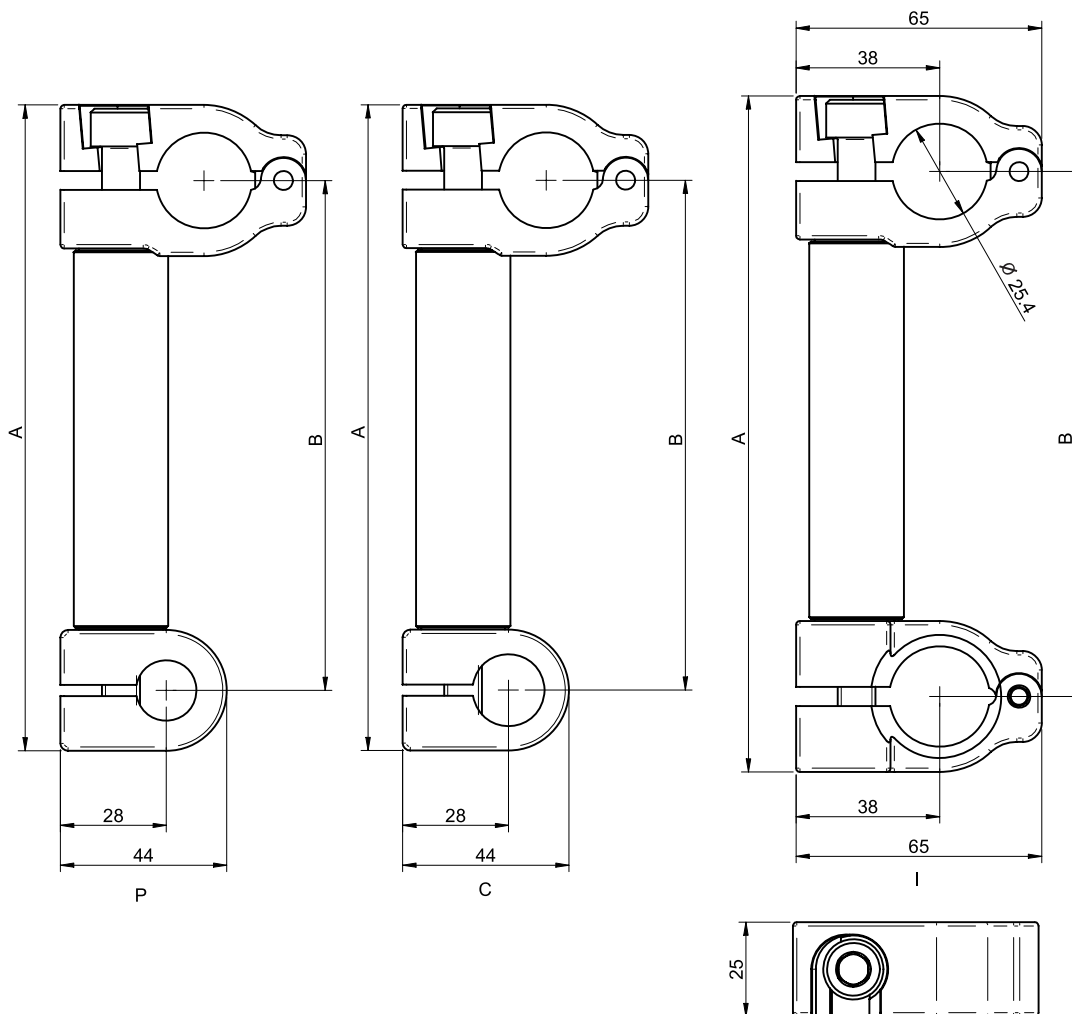

## DIMENSIONS

Description	Rod extension length 50 mm		Rod extension length 100 mm		Rod extension length 150 mm	
	A mm	B mm	A mm	B mm	A mm	B mm
Bar clamp, clamp-on 25 mm, pin 16	121	86	171	136	221	186
Bar clamp, clamp-on 25 mm, pin 19	121	86	171	136	221	186
Bar clamp, clamp-on 25 mm, ball joint	129	90	179	140	229	190