

## Xi10-3 FS



- ▶ Three-stage COAX® cartridge - MINI.
- ▶ Includes a flow-through silencer and a built-in vacuum filter for harsh environments.
- ▶ High vacuum flow at deep vacuum levels to 94 - kPa.
- ▶ Quick response time when deep vacuum is needed.
- ▶ Suitable for handling sealed objects with high pick-up speed.
- ▶ Large vacuum flow in relation to energy consumption.

### TECHNICAL DATA

Description	Unit	Value
Feed pressure, max.	MPa	0.7
Temperature range	°C	-10-80
Weight	g	11.4
Material		NBR, PA, PP, SS

### VACUUM FLOW

Feed pressure MPa	Air consumption NI/s	Vacuum flow (NI/s) at different vacuum levels (-kPa)										Max vacuum -kPa
		0	10	20	30	40	50	60	70	80	90	
0.45	0.42	1.39	0.64	0.46	0.28	0.19	0.15	0.11	0.07	0.043	0.003	92
0.5	0.46	1.43	0.70	0.50	0.33	0.19	0.15	0.11	0.07	0.045	0.011	94
0.6	0.54	1.45	0.79	0.53	0.42	0.30	0.16	0.11	0.08	0.041	0.010	93

### EVACUATION TIME

Feed pressure MPa	Air consumption NI/s	Evacuation time (s/l) to reach different vacuum levels (-kPa)										Max vacuum -kPa
		10	20	30	40	50	60	70	80	90		
0.45	0.42	0.1	0.28	0.55	1.0	1.5	2.2	3.4	5.2	9.5	92	
0.5	0.46	0.09	0.26	0.50	0.90	1.5	2.2	3.4	5.2	8.8	94	
0.6	0.54	0.09	0.24	0.45	0.70	1.2	1.9	3.0	4.7	8.6	93	

### BLOW FLOW

Feed pressure MPa	Air consumption NI/s	Blow flow (NI/s) at different pressure levels (kPa)										Max pressure kPa
		0	10	20	30	40	50	60	70	80		
0.6	0.54	1.8	1.3	1.1	0.98	0.85	0.84	0.79	0.71	0.61	90	

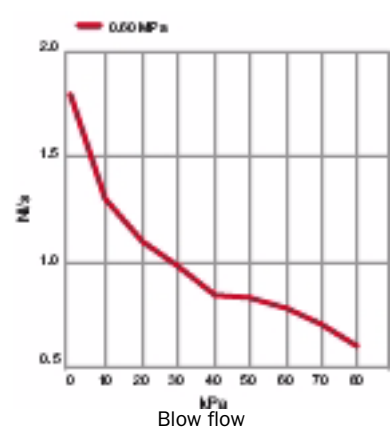
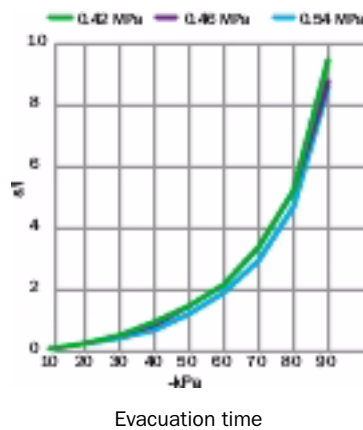
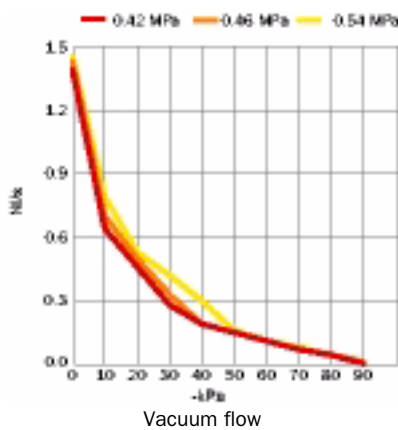

## ORDERING INFORMATION

	Description	Art. No.
E	COAX® cartridge MINI Xi10-3, holding cap silencer, vacuum filter	0120775
F	COAX® cartridge MINI Xi10-3, extra non-return valve, holding cap silencer, vacuum filter	0120776

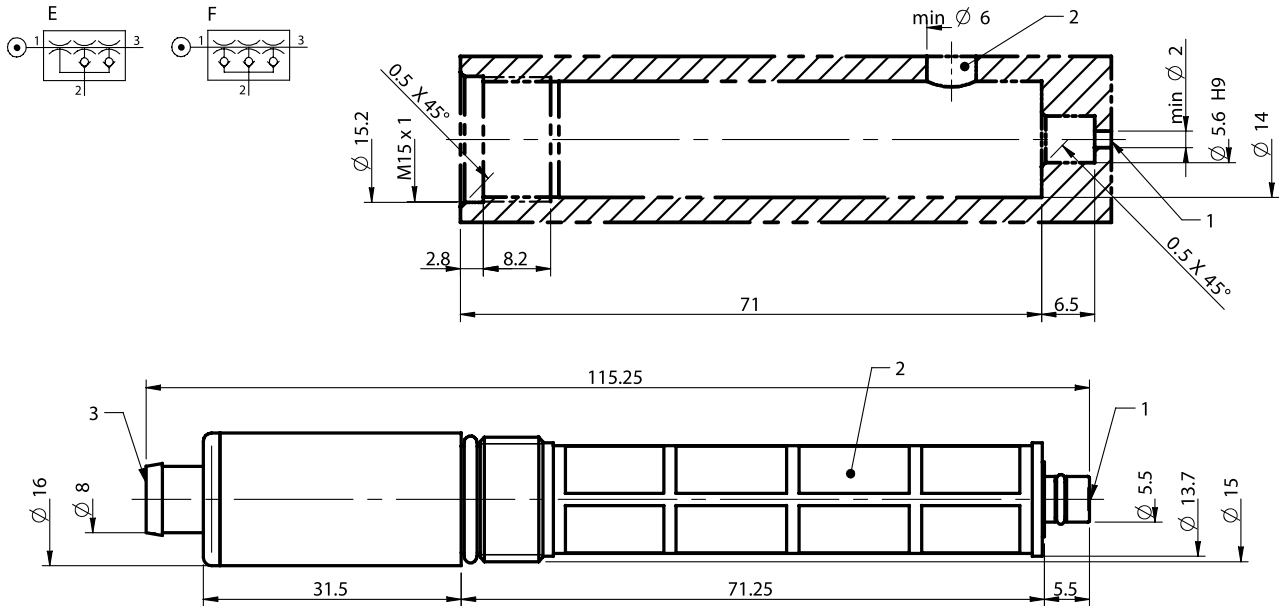

## ORDERING INFORMATION, ACCESSORIES

	Description	Art. No.
	Silencer COAX® MINI	0111977
	Exhaust adapter	0106344