

# Level switch NS 64 / NS 100 ..-AM

## ***Level switch NS for external installation***

- visual and electric surveillance of liquid level
- pressure range up to 100 bar
- lengths up to 5000 mm
- adjustable level contacts
- optional analogue output 4-20 mA
- visual indication with scale
- robust design meets industrial standards
- float with dynamic buoyancy
- specials upon request

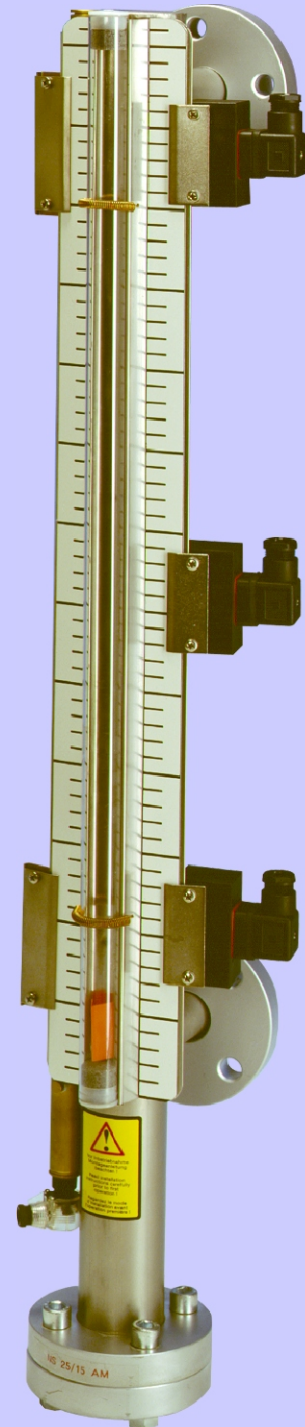

## Technical data

## NS 64 AM

### Basic data

|                             |                         |
|-----------------------------|-------------------------|
| max. operating pressure     | 64 bar                  |
| max. operating temperature  | 50 °C                   |
| min. spec. density of fluid | 0,85 kg/dm <sup>3</sup> |
| weight at L1=500 mm         | approx. 32 kg           |
| weight L1+ 100 mm           | approx .0,5kg           |

### Material

|             |         |
|-------------|---------|
| float SK596 | plastic |
| stand pipe  | 1.4571  |
| flange      | steel   |
| sight glass | PC      |

### Connector

|                 |      |
|-----------------|------|
| flange DIN 2637 | DN25 |
| øD              | 140  |
| øk              | 100  |
| ød              | 18   |
| b               | 22   |
| øA              | 68   |
| h               | 2    |

other designs on request

appropriate level contacts see on page 4

### Option

|                                     |  |                                      |
|-------------------------------------|--|--------------------------------------|
| <b>transducer tube</b>              | <b>-K</b> continuous level             | O<br>P<br>T<br>I<br>O<br>N<br>A<br>L |
| measurement principle               | reed contact                           |                                      |
| resolution                          | 5 or 10 mm                             |                                      |
| operating voltage (U <sub>B</sub> ) | 10 - 30 V DC                           |                                      |
| output                              | 4 - 20 mA<br>(nominal voltage 24 V DC) |                                      |
| load Ω max.                         | (U <sub>B</sub> - 7,5 V) / 0,02 A      |                                      |

### Accessories:

|           |                                 |
|-----------|---------------------------------|
| Part No.  |                                 |
| 22 54 000 | flange gasket 65/25x2 mm (DN25) |
| 22 73 999 | fixing bolts 8 x M16x70         |

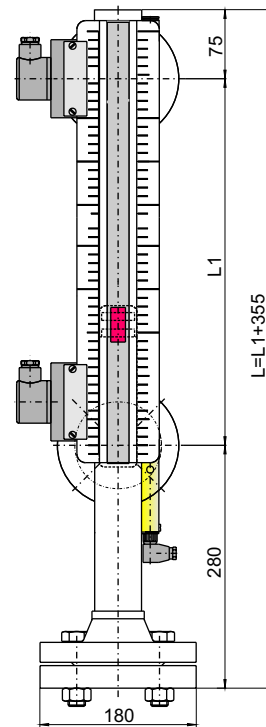
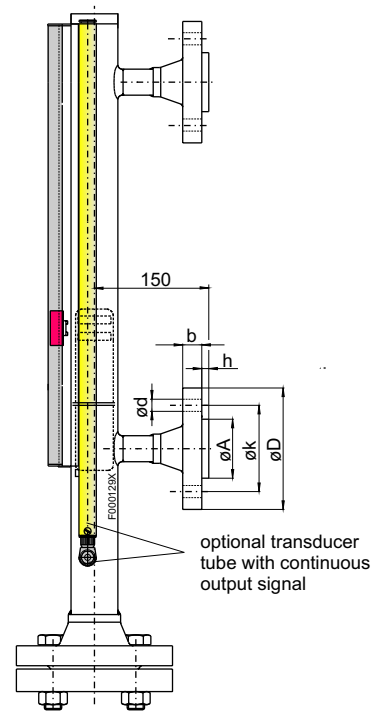

## Product code for NS 64

NS 64/25AM  SK596 /

Length  
L1 = ...mm

|   |                                   |
|---|-----------------------------------|
| O | Option transducer tube            |
| P | -K5 continuous, resolution 5 mm   |
| T | -K10 continuous, resolution 10 mm |

### Example for order

You need: Level switch for external mounting, operating pressure max. 64 bar, with flange connector DN25, stub distance L1 = 1400 mm, with 2 change over contacts (see on page 4)

You order: NS 64/25-AM-SK596 / 1400  
2 x Part No. 28 89 999; contact MKS - 1/W

## Technical data

## NS 100 AM

### Basic data

|                             |                         |
|-----------------------------|-------------------------|
| max. operating pressure     | 100 bar                 |
| max. operating temperature  | 50 °C                   |
| min. spec. density of fluid | 0,85 kg/dm <sup>3</sup> |
| weight at L1=500mm          | approx. 35 kg           |
| weight L1+ 100mm            | 0,5 kg                  |

### Material

|             |         |
|-------------|---------|
| float SK596 | plastic |
| stand pipe  | 1.4571  |
| flange      | steel   |
| sight glass | PC      |

### Connector

|                 |      |
|-----------------|------|
| flange DIN 2637 | DN25 |
| øD              | 140  |
| øk              | 100  |
| ød              | 18   |
| b               | 22   |
| øA              | 68   |
| h               | 2    |

other designs on request

appropriate level contacts see on page 4

### Option

|                                    |  |                                      |
|------------------------------------|--|--------------------------------------|
| <b>transducer tube</b>             | <b>-K</b> continuous level             | O<br>P<br>T<br>I<br>O<br>N<br>A<br>L |
| measurement principle              | reed contact                           |                                      |
| resolution                         | 5 or 10 mm                             |                                      |
| operating voltage(U <sub>B</sub> ) | 10 - 30 V DC                           |                                      |
| output                             | 4 - 20 mA<br>(nominal voltage 24 V DC) |                                      |
| load Ω max.                        | (U <sub>B</sub> - 7,5 V) / 0,02 A      |                                      |

### Accessories:

|           |                                 |
|-----------|---------------------------------|
| Part No.  |                                 |
| 22 54 000 | flange gasket 65/25x2 mm (DN25) |
| 22 73 999 | fixing bolts 8 x M16x70         |

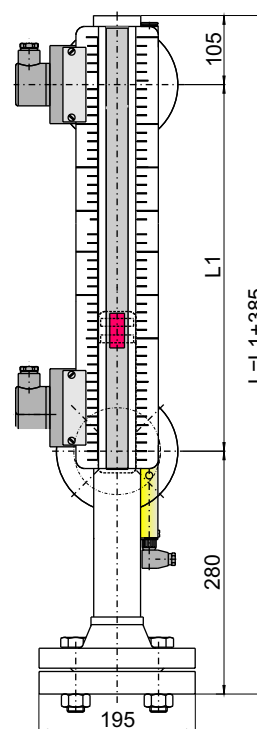
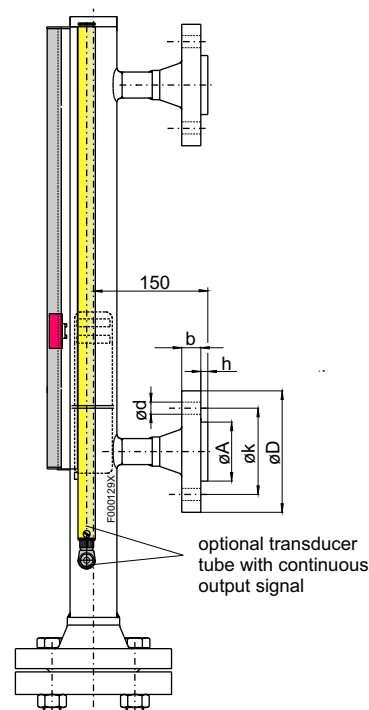

## Product code for NS 100

NS 100/25AM  -SK596 /

|   |        |                             |
|---|--------|-----------------------------|
| O | Option | transducer tube             |
| P | -K5    | continuous resolution 5 mm  |
| T | -K10   | continuous resolution 10 mm |

Length  
L1 = ...mm

### Example for order

You need: Level switch for external mounting, operating pressure max. 100 bar, with flange connector DN25, stub distance L1 = 1500 mm, continuous level output, resolution 5 mm and with 2 change over contacts (see on page 4)

You order: NS 100/25-AM-K5-SK596 / 1500  
2 x Part. No. 28 89 999 contact MKS 1/W

# Contacts for NS ..-AM

## Pin assignment (contact position empty reservoir)

mounting left

mounting right

Type **MKS-1/K**  
 function NC / NO  
 max. voltage 230 V AC/DC  
 max. current 1 A  
 max. contact load 50 VA  
 connector M3 (DIN EN 175301-803)  
 3 pol. + PE  
 protection class IP 65  
**Part No.** 28 88 999

Type **MKS-2/K**  
 function 2 x NC / NO  
 max. voltage 230 V AC/DC  
 max. current 1 A  
 max. contact load 50 VA  
 connector S6 (DIN EN 175201-804)  
 6 pol. + PE  
 protection class IP 65  
**Part No.** 28 91 999

Type **MKS-1/W**  
 function change over  
 max. voltage 230 V AC/DC  
 max. current 1 A  
 max. contact load 50 VA  
 connector M3 (DIN EN 175301-803)  
 3 pol. + PE  
 protection class IP 65  
**Part No.** 28 89 999

Type **MKS-1/W-L 24 V**  
 function change over with LED  
 max. voltage 24 V DC  
 max. current 1 A  
 max. contact load 50 VA  
 connector S6 (DIN EN 175201-804)  
 6 pol. + PE  
 protection class IP 65  
**Part No.** 28 90 999

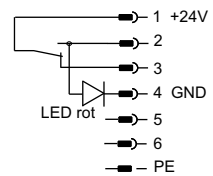
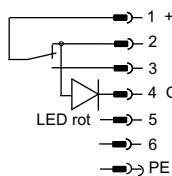
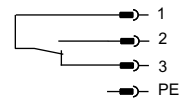
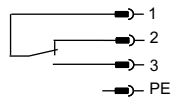
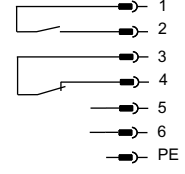
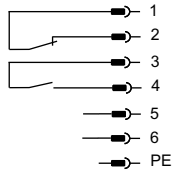
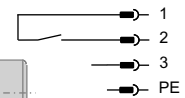
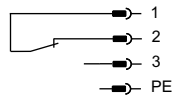

other contacts on request

For operations in areas with strong vibrations we suggest to use contacts MKS-1/K and MKS-2K.

When mounting a transducer tube with continuous output signals you have to keep in mind that the mounting of contacts is possible only on the left side.

## Pin assignment for AM-K with connector S3

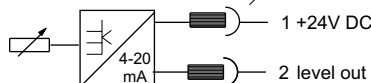

**MKS 1/K  
MKS 1/W**

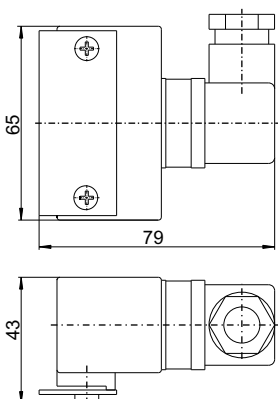

**MKS 2/K**

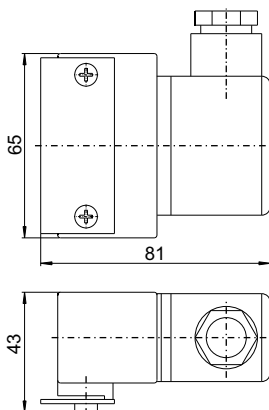

**MKS 1/W-L24V**

